

# How to create a tile on your mobile device that uses iOS or Android OS

## iOS

Open your browser and navigate to "[www.parentpay.com](http://www.parentpay.com)".

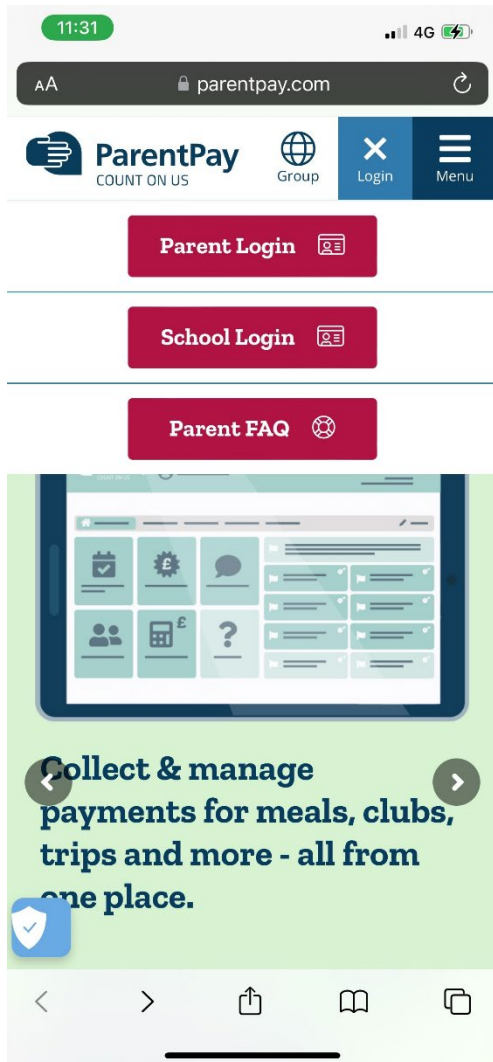

1. Tap **Login** and select **Parent Login**.

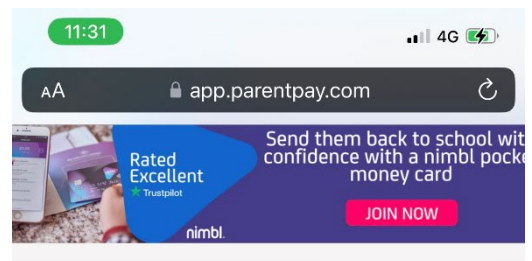

Login

**Important:** Existing users adding a child, please [read our help document](#) or [watch our video: How to add a child to an existing account](#)

Email/Username

Password

[Forgotten your password?](#)

2. If this is the first time on this page, an automated pop-up will appear. Follow these instructions. If not, tap the **Share icon**.

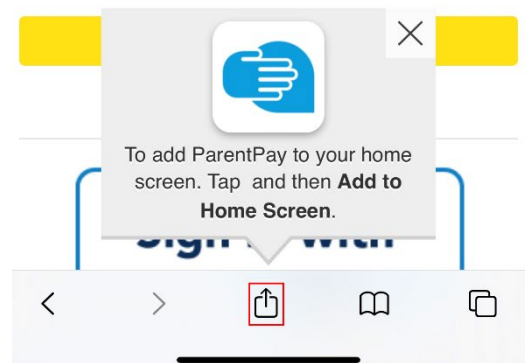

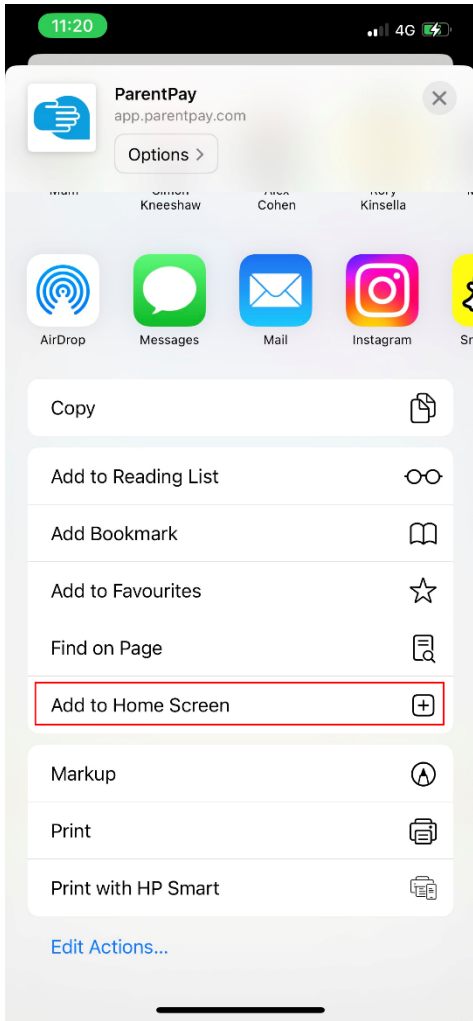

3. Next, tap **Add to Home Screen**.

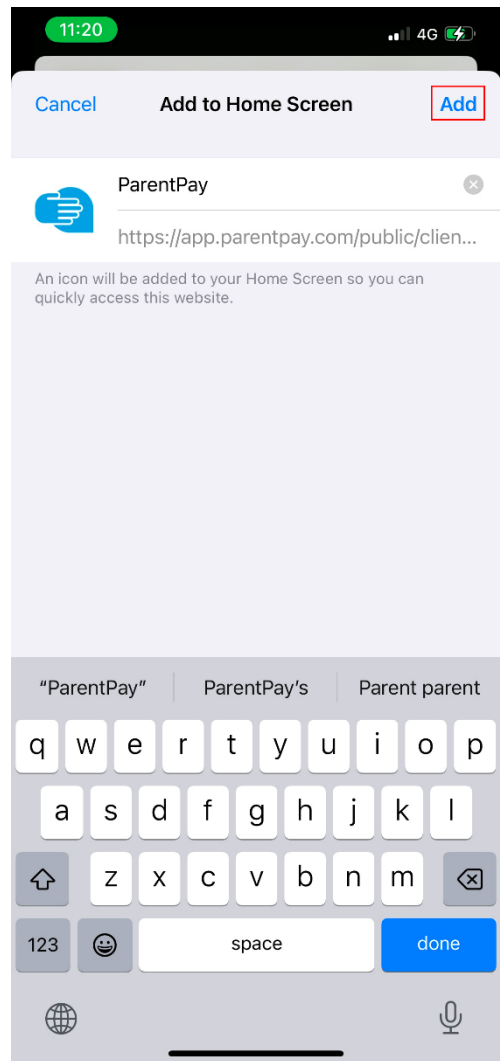

4. Tap **Add**.



5. The ParentPay tile will now appear on your home screen.

# Android OS

Open your browser and navigate to "[www.parentpay.com](http://www.parentpay.com)".

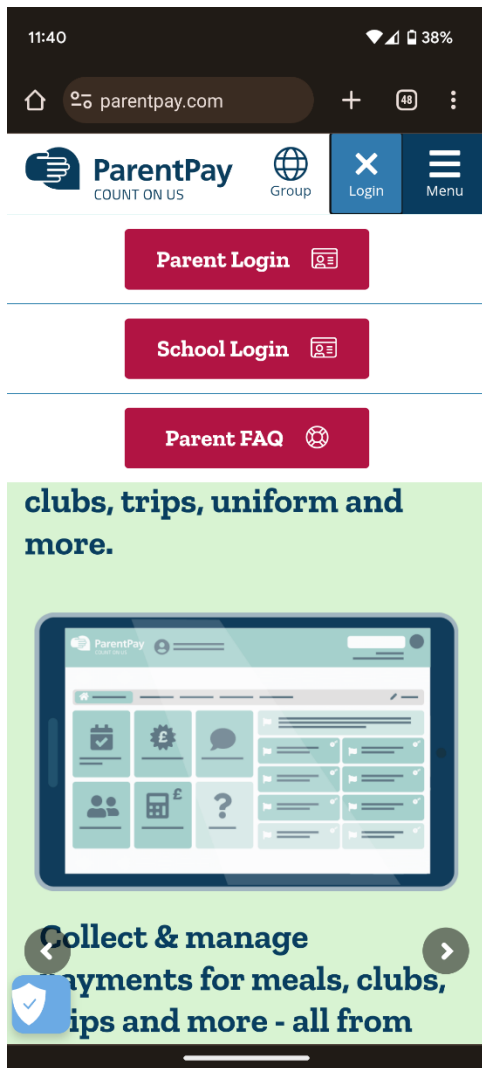

1. Tap **Login** and select **Parent Login**.

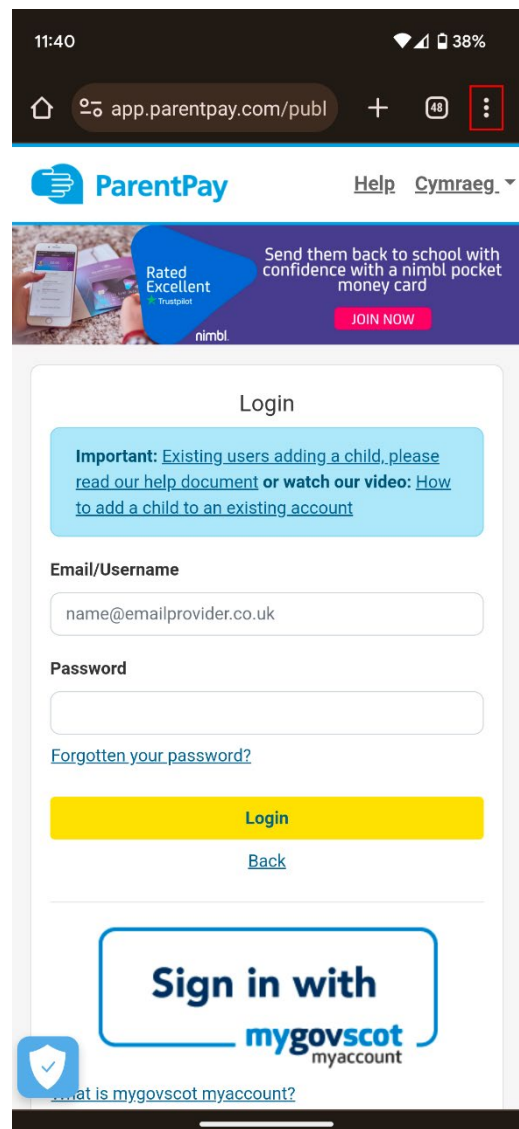

2. Tap the **3 dots** to open the drop-down menu

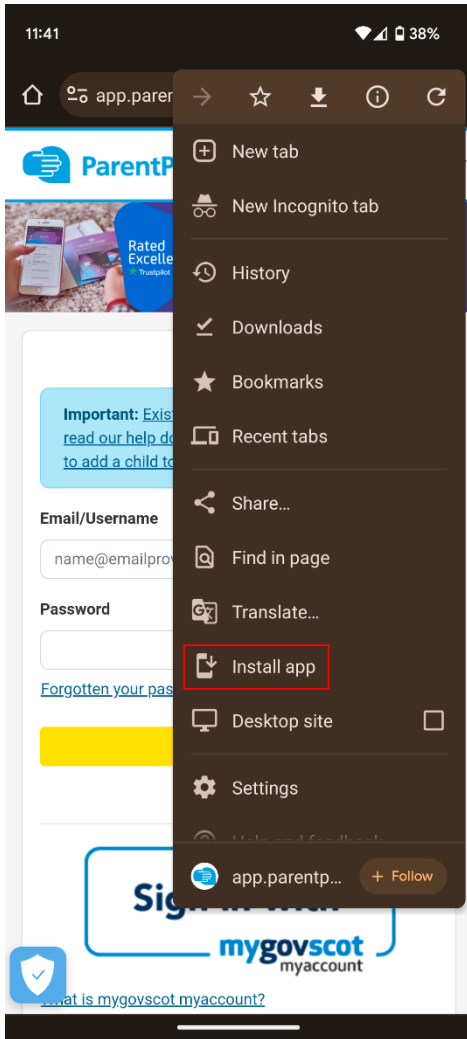

3. Select **Install App**

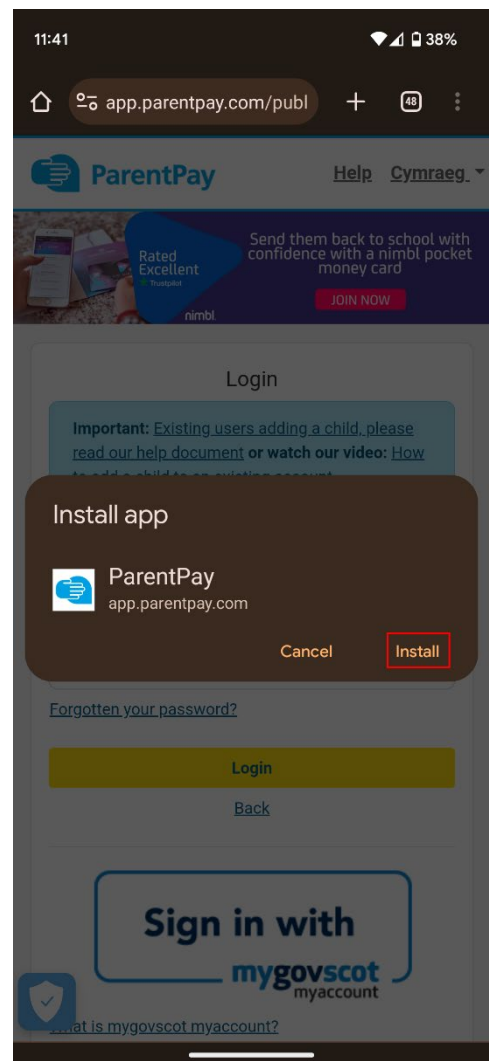

4. Next, tap **Install**

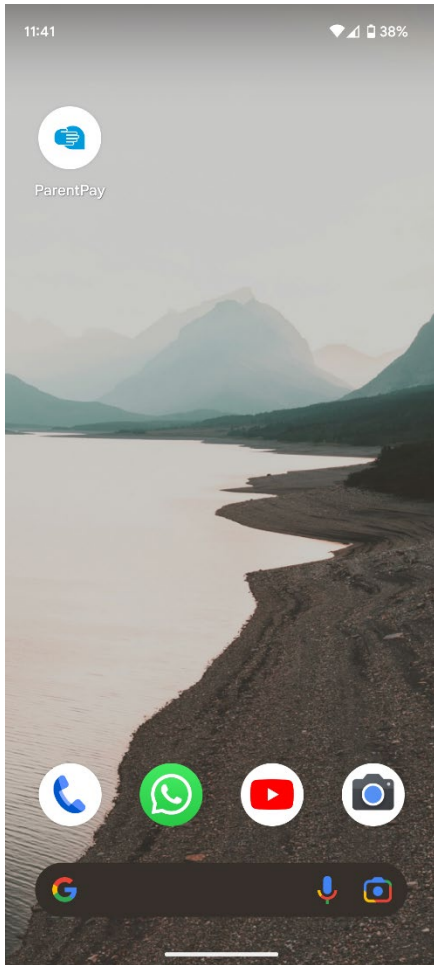

5. The ParentPay tile will now appear on your home screen.